

Portland State University

PDXScholar

Critlib Unconference

Critlib 2015

Mar 25th, 9:00 AM

Conference Program

Critlib Unconference 2015 Administrators

Follow this and additional works at: <https://pdxscholar.library.pdx.edu/critlib>



Part of the [Library and Information Science Commons](#)

Let us know how access to this document benefits you.

Critlib Unconference 2015 Administrators, "Conference Program" (2015). *Critlib Unconference*. 17.
<https://pdxscholar.library.pdx.edu/critlib/2015/Conference/17>

This Event is brought to you for free and open access. It has been accepted for inclusion in Critlib Unconference by an authorized administrator of PDXScholar. Please contact us if we can make this document more accessible:
pdxscholar@pdx.edu.

ACRL

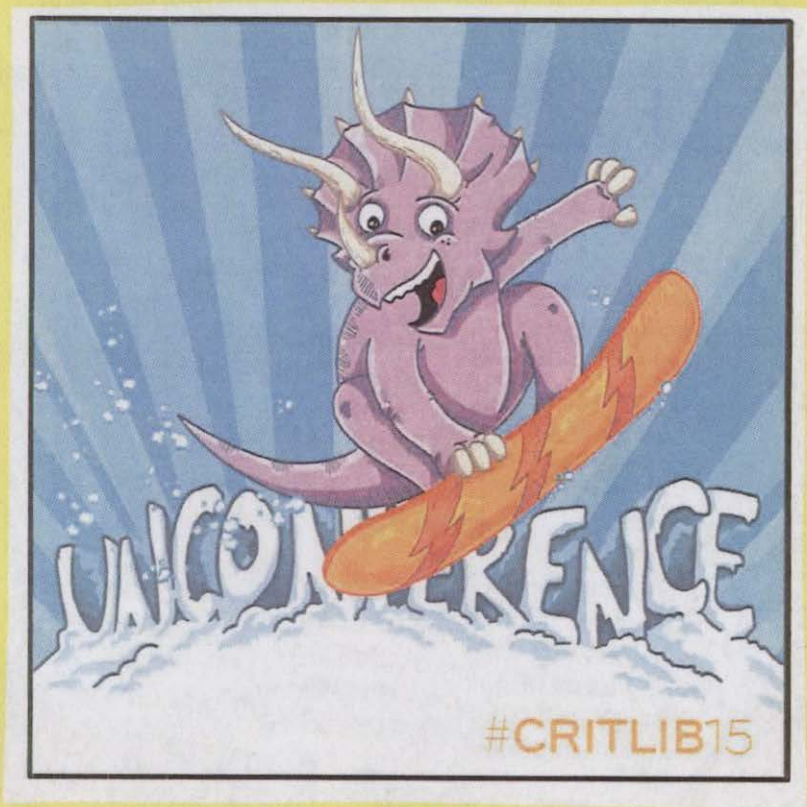

PD X

2015

Welcome to the CritLib Unconference!!!!

Library instruction, assessment, cataloging and classification, collection building, staffing, administration, and other functions of academic libraries are all political projects that librarians undertake inside institutions that operate under capitalist, patriarchal, and racist power structures that many of us aim to contest. How do we do this in both theory and practice?

... Red Roses

As we explore these topics together, please keep the following things in mind:

- Whoever shows up are the right people.
- Whatever happens is what is supposed to happen.
- Rule of two feet: if you're not learning/contributing in one space, feel free to get up and find another conversation.

Each session should have a:

- facilitator (who keeps the conversation moving and ensures that everyone has an opportunity to speak)
- note-taker (who takes notes in some format that can be posted to the shared document:
<https://etherpad.wikimedia.org/p/critlibuncon>)

If you're posting notes/photos/thoughts online, please tag with #critlib15!

Key point from the Code of Conduct

Harassment includes offensive verbal comments related to race, ethnicity, sex, gender identity or expression, sexual orientation, country of origin, age, disability, physical appearance, body size, religion, veteran status or other protected class status; discriminatory or offensive images in public spaces; intimidation; stalking; harassing or unwanted photography or recording; sustained disruption of talks or other events; inappropriate physical contact; and unwelcome sexual attention. Participants violating the anti-harassment policy may be warned or asked to leave by unconference organizers.

We see the unconference as a place to share information, not only with other participants, but also with those who may not be able to attend. Sessions are, by default, considered open and can be written about on social media and photographed. If you do not want your picture taken, your words to be recorded or for either photographs or words to be attributed to you, please let other session participants know that. As a courtesy, please always ask prior to creating sound or video recordings of any sessions. Please be thoughtful and respectful with your photographs, recording, and sharing.

If at any point during the unconference you feel uncomfortable or harassed, or if you witness any violations of these policies, please reach out to any of the unconference organizers, who are wearing armbands.

Chrysler Imperial

		Hoffman Hall main space/A	Hoffman Hall B	Hoffman Hall C	Hoffman Hall D	library room 160	Hoffman lobby 1 GUERRILLA sessions	Hoffman lobby 2
8:30-9:00	nametags & muffins		X	X	X	X	X	X
9:00-9:30	planning	PLENARY	X	X	X	X	X	X
9:30-10:30	session 1							
10:30-10:45	break							
10:45-11:45	session 2							
11:45-12:45	lunch							
12:45-1:30	session 3							
1:30-1:45	break							
1:45-2:30	lightning talks							
2:30-3:00	takeaways feelings	PLENARY	X	X	X	X	X	X

B-I-N-G-O

Can you get bingo sometime today? If you fill in five in a row, any direction, shout "BINGO!" and win a fabulous prize!

Twitter feed more active than discussin

conferena sticker on laptop

"I want to go to EVERY thing!"

Slide w/cats on it

"I've been meaning to read that..."

discussion of microbrews

hugging it out

Clif or Lara bar

lost water bottle

"neo-liberal"

cat-embellished clothing

ACRL framework

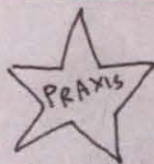

"I think I need more coffee..."

Portlandia joke

meeting someone you know from the internet

"F*CK one-shots!"

embroidered cardigan

we run out of tea

cat-eye glasses

#critlib group photo

Mauras Seale + Smale in the same group

LIS-related t-shirt

Vegan food truck

Dansko clogs

Wifi

1. Select the Wi-Fi network PSU Guest.
2. Open a web browser and visit any website. You will be redirected to the PSU Guest Wi-Fi Access page.
3. Enter all the required information and select the Register by Email button.
4. Check your email for a message from PSU. If you do not see the message within a couple of minutes, please check your spam folder. Open the message and click the confirmation link.

Organizers

Anne Leonard, Annie Pho, Ann Matsuuchi, Bob Schroeder, Candise Branum, Ian Beilin, Jenna Freedman, Kelly McElroy, Maura Smale, Nicole Pagowsky, and Turner Masland.

Today was made possible thanks to everyone who donated their time and money. Special thanks to Portland State University Library for hosting, to Jennifer Starkey for coffee, to graphic designer Ryan Mason who created our dinosaur friend, and to the McElroys for bingo prizes.

Lavender Pinocchio

If you're headed to ACRL, check out this list of #critlib-ish sessions: <http://bit.ly/1MRVcm2>

LUNCH

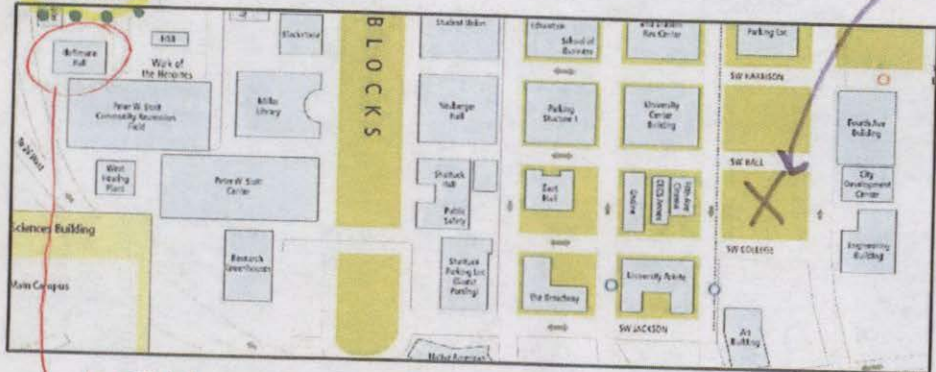

FOOD
CARTS

HOFFMAN
HALL

TO THE CONVENTION CENTER

Should take 25-30 minutes.

Walk 1/3 mile to PSU Urban Center/SW 6th & Montgomery MAX Stn Stop ID 7774

Board MAX Green Line to Clackamas Town Center

Get off at Convention Center MAX Station Stop

Walk 570 feet to Oregon Convention Center



©2013 NAVTEO, INC.